



**Installation of  
Combo/SuperDrive Upgrade  
PowerBook G3 Lombard & Pismo (Firewire)**

For Customer Service and Technical Support  
email: [support@fastmac.com](mailto:support@fastmac.com) or phone: 408.850.6232



## Before You Begin/Preparation

Thank you for choosing FastMac. Please feel free to contact us at any time with any questions or comments you may have while installing your new Combo/SuperDrive.



**!** **IMPORTANT!** Before doing any work on your PowerBook, **BACK UP ALL IMPORTANT DATA** from your hard drive! FastMac is not responsible for any loss of data during the upgrade process!

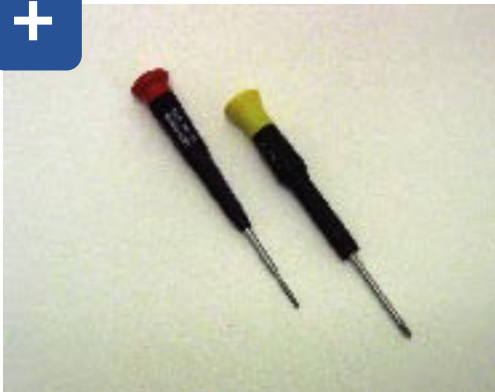

**+** **Tools needed:** Philips screwdriver (Size 0)  
Philips screwdriver (Size 000)

## Part I: Optical Drive Removal Procedure:

Estimated time: 6 min

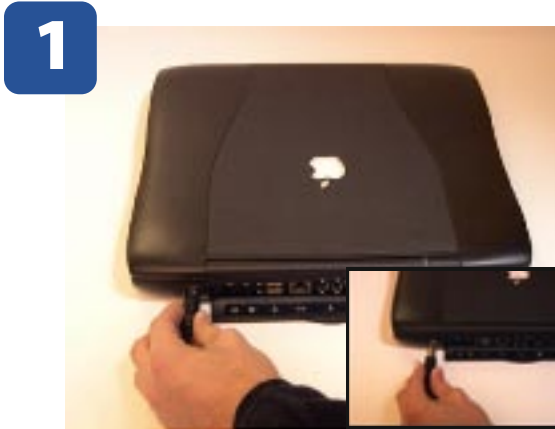

1. Shut down the computer. Unplug all cables, including the AC adapter. Wait five (5) minutes for components to cool.



2. Remove the optical drive from the expansion bay by pulling the lever at the corner of the PowerBook towards you. Do this, preferably, in a clean, dry, well-lit area.



3. Remove the two (2) Phillips screws (#000) located on the left side of the drive enclosure (front bezel facing you).



- 3a. Remove the two (2) Phillips screws (#000) located on the right side of the drive enclosure (front bezel facing you).

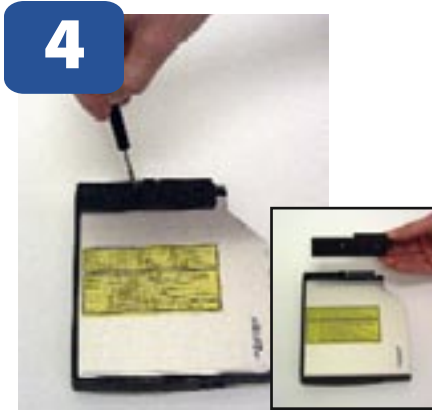

4. Remove the two (2) Phillips screws (#00) located on the top of the drive enclosure. Then remove the black interconnect board cover.

*Note: These are larger than the four (4) screws you have just removed from the sides of the drive enclosure. Please keep these separate from the other screws.*



7. Remove the drive from the enclosure by lifting up on the right side of the drive and then slide it to the right and out of the drive enclosure.



6. Open the Optical Drive by pressing the manual eject button located on the front bezel, with the Phillips Screw-driver.



8. Remove the Interconnect Board from the optical drive.

## Part 2: Combo/Super Drive Installation Procedure:

Estimated time: 6 min



8. Remove the Combo/Super Drive from the Anti-Static bag.

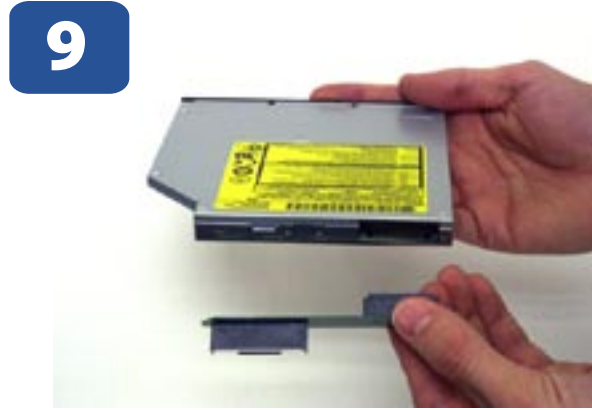

9. Attach the Interconnect Board to the Combo/Super Drive.

*Note: The connector should fit securely in place and the board should be parallel to the Combo/Super Drive.*



10. Place the Combo/Super Drive back into the enclosure. To do this position the left side under the enclosure lip and then slowly lower the right side down until it fits securely into position.

*Note: The yellow label should be facing up, and the Interconnect Board should fit between the screw holes.*



11. Replace the black interconnect board cover and attach the two (2) larger screws to it.

*Note: The screw holes will line up when the cover is in the correct position and flush with the rest of the enclosure.*



13. Attach the Combo/Super Drive to the enclosure using the four (4) screws.

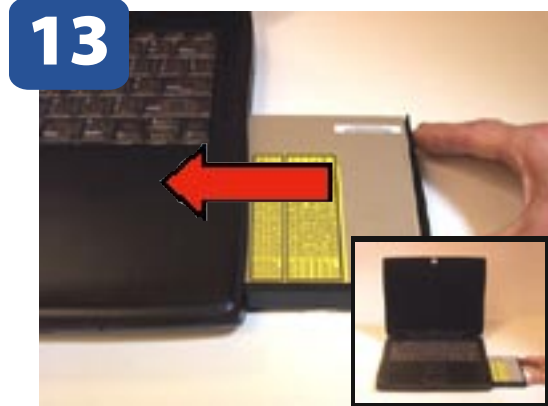

14. Slide the Combo/Super Drive into the expansion bay. You will hear a click confirming that it is in the correct & secure position.



15. Reattach all cables including the AC adapter.



16. Power on your computer.

This ends the hardware installation portion of your upgrade. Please continue on with the software installation depending on your Operating System & Optical Drive.



**Part 3: Software Installation Procedure:**  
 Estimated time: 6 min

**Step 1**

**Step 2**



**OS 9.2.x Instructions**

	For CD/DVD Burning functionality Navigate to your System Folder - Extensions - Authoring Support Files.
<b>1x</b>	No removal needed
<b>2x, 4x, 8x or Matsushita Combo Drive</b>	Remove the file labeled "Matsushita CDR" file & place it into the extensions disabled folder
<b>Sony Combo Drive</b>	Remove the file labeled "Sony CDR" file & place it into the extensions disabled folder

	Place the following file into the System folder. The file will automatically go to the Authoring Support Folder. Then Restart
<b>1x</b>	None
<b>2x</b>	FMMatSuper2X
<b>4x</b>	FMMatSuper4X
<b>8x</b>	FMMatSuper8X
<b>Combo Drive Matsushita</b>	FMMatComb
<b>Combo Drive Sony</b>	FMSonyComb



**OS 10.3.x Instructions**

	For CD/DVD Burning Functionality run the following included application
<b>1x</b>	None
<b>2x</b>	PatchBurn 3
<b>4x</b>	PatchBurn 3
<b>8x</b>	PatchBurn 3
<b>Combo Drive Matsushita</b>	None
<b>Combo Drive Sony</b>	PatchBurn 3

You are now finished installing your Combo/Super Drive.

We hope you enjoy your new Combo/SuperDrive equipped PowerBook and thank you again for choosing FastMac.



### Limited Warranty Information

FastMac's limited warranty: This product is warranted by FastMac.com to be free from defects in material and workmanship for one (1) year from the date of purchase by the Purchaser.

Purchaser's sole remedy under this warranty shall be, at FastMac's sole discretion, refund, repair or replacement as provided in this warranty. FastMac's warranty shall not apply to any failure or defect caused by misuse, abnormal use, neglect, abuse, alteration, improper installation, unauthorized repair or modification, improper testing, accident or causes external to the product such as but not limited to excessive heat or humidity, power failure, or surges, or improper installation, or damage arising from improper packaging during transport; and damage resulting from causes, including without limitation, lack of technical skill, competence, or experience of the user.

FASTMAC IS NOT RESPONSIBLE FOR DIRECT, SPECIAL, INCIDENTAL OR CONSEQUENTIAL DAMAGES RESULTING FROM ANY BREACH OF WARRANTY OR CONDITION, OR UNDER ANY OTHER LEGAL THEORY, INCLUDING BUT NOT LIMITED TO LOST PROFITS, DOWNTIME, GOODWILL, DAMAGE TO OR REPLACEMENT OF EQUIPMENT AND PROPERTY, ANY COSTS OF RECOVERING, REPROGRAMMING, OR REPRODUCING ANY PROGRAM OR DATA STORED IN OR USED WITH FASTMAC PRODUCTS, AND ANY FAILURE TO MAINTAIN THE CONFIDENTIALITY OF DATA STORED ON THE PRODUCT. FASTMAC SPECIFICALLY DOES NOT REPRESENT THAT IT WILL BE ABLE TO REPAIR ANY PRODUCT UNDER THIS WARRANTY OR MAKE A PRODUCT EXCHANGE WITHOUT RISK TO OR LOSS OF PROGRAMS OR DATA. Some states do not allow the exclusion or limitation of incidental or consequential damages or exclusions or limitations on the duration of implied warranties or conditions, so the above limitations or exclusions may not apply to you. This warranty gives you specific legal rights, and you may also have other rights that vary by state.

Use of software and /or configurations are at your own risk and are not considered covered under any warranty. FastMac and its associates are not liable for damages resulting from the use of the instructions or software provided.

Non-defective purchases which are returned to FastMac must be returned within thirty (30) days of purchase. For non-defective purchases which are returned or refused by the Purchaser, FastMac will, at its discretion, issue a credit or refund for the purchase price of the goods, less all shipping charges incurred in the shipment and a restocking fee of no less than fifteen percent (15%) of the price of the goods.